

**FILTRO LINEA EL.
LINE FILTER PE.
FILTRE DROIT BL.
FILTRO LÍNEA EL.**

400 L

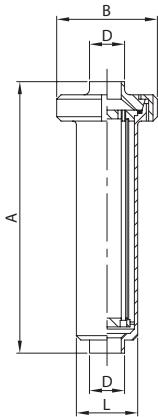

| DN | A | B | D | L | gr |
|-----|-------|-------|-------|-------|-------|
| 25 | 320,0 | 112,0 | 25,4 | 70,0 | 3.000 |
| 38 | 320,0 | 112,0 | 38,1 | 70,0 | 3.000 |
| 51 | 420,0 | 112,0 | 50,8 | 70,0 | 3.300 |
| 63 | 516,0 | 127,0 | 63,5 | 85,0 | 4.650 |
| 76 | 574,0 | 148,0 | 76,2 | 102,0 | 5.700 |
| 101 | 700,0 | 148,0 | 101,6 | 129,0 | 7.000 |

**FILTRO LINEA EF./BL. MR.
LINE FILTER ME./L. EG.
FILTRE DROIT BF./PL. DR.
FILTRO LÍNEA ER./C. MR.**

401 S

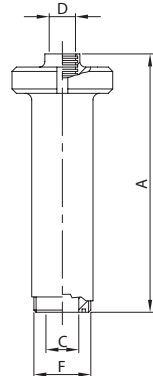

| DN | A | C | D | F | gr |
|-----|-------|------|-------|-------|-------|
| 25 | 327,0 | 22,4 | 25,4 | 40-6 | 3.070 |
| 38 | 327,0 | 35,1 | 38,1 | 60-6 | 3.200 |
| 51 | 427,0 | 47,8 | 50,8 | 70-6 | 3.525 |
| 63 | 529,0 | 60,5 | 63,5 | 85-6 | 5.040 |
| 76 | 594,0 | 72,9 | 76,2 | 98-6 | 6.200 |
| 101 | 700,0 | 97,6 | 101,6 | 132-6 | 8.140 |

**FILTRO 90° EL.
90° FILTER PE.
FILTRE 90° BL.
FILTRO 90° EL.**

410 L

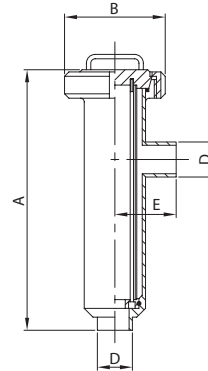

| DN | A | B | D | E | gr |
|-----|-------|-------|-------|-------|-------|
| 25 | 307,0 | 112,0 | 25,4 | 70,0 | 3.100 |
| 38 | 307,0 | 112,0 | 38,1 | 70,0 | 3.100 |
| 51 | 407,0 | 112,0 | 50,8 | 82,0 | 3.400 |
| 63 | 503,0 | 127,0 | 63,5 | 85,0 | 4.800 |
| 76 | 561,0 | 148,0 | 76,2 | 96,0 | 5.900 |
| 101 | 662,0 | 148,0 | 101,6 | 117,0 | 7.200 |

**FILTRO 90° EF./EL.
90° FILTER ME./PE.
FILTRE 90° BF./BL.
FILTRO 90° ER./EL.**

411 S

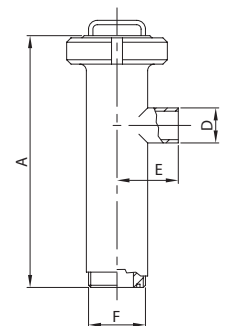

| DN | A | D | E | F | gr |
|-----|-------|-------|-------|-------|-------|
| 25 | 306,0 | 25,4 | 70,0 | 40-6 | 3.170 |
| 38 | 306,0 | 38,1 | 70,0 | 60-6 | 3.300 |
| 51 | 405,0 | 50,8 | 72,0 | 70-6 | 3.620 |
| 63 | 503,0 | 63,5 | 85,0 | 85-6 | 5.190 |
| 76 | 561,0 | 76,2 | 96,0 | 98-6 | 6.400 |
| 101 | 652,0 | 101,6 | 117,0 | 132-6 | 8.340 |

**FILTRO 90° EF./EF.
90° FILTER ME./ME.
FILTRE 90° BF./BF.
FILTRO 90° ER./ER.**

412 S

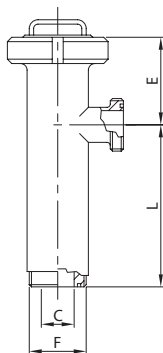

| DN | C | E | F | L | gr |
|-----|------|-------|-------|-------|-------|
| 25 | 22,4 | 99,0 | 40-6 | 207,0 | 3.240 |
| 38 | 35,1 | 99,0 | 60-6 | 207,0 | 3.500 |
| 51 | 47,8 | 115,0 | 70-6 | 290,0 | 3.850 |
| 63 | 60,5 | 117,0 | 85-6 | 386,0 | 5.580 |
| 76 | 72,9 | 131,0 | 98-6 | 430,0 | 6.900 |
| 101 | 97,6 | 120,0 | 132-6 | 532,0 | 9.480 |

**RIVESTIMENTO MESH
MESH COVERING
MESH GRILLE
REVESTIMIENTO MESH**

400 612



| DN | MESH |
|-------|---------------------|
| 25/40 | 100/200 300 400 500 |
| 51/52 | 100/200 300 400 500 |
| 63/70 | 100/200 300 400 500 |
| 76/85 | 100/200 300 400 500 |
| 101 | 100/200 300 400 500 |

**CARTUCCIA FILTRO LINEA
LINE FILTER CARTRIDGE
TAMIS FILTRE DROIT
CARTUCHO FILTRO LÍNEA**

400 410

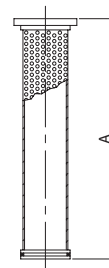

| DN | A |
|-------|-------|
| 25/40 | 271,0 |
| 51/52 | 371,0 |
| 63/70 | 466,0 |
| 76/85 | 516,0 |
| 101 | 621,0 |

**CARTUCCIA FILTRO 90°
90° FILTER CARTRIDGE
TAMIS FILTRE 90°
CARTUCHO FILTRO 90°**

410 410

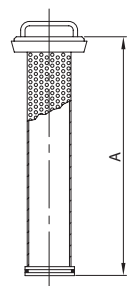

| DN | A |
|-------|-------|
| 25/40 | 278,0 |
| 51/52 | 378,0 |
| 63/70 | 473,0 |
| 76/85 | 527,0 |
| 101 | 636,0 |

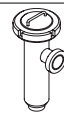

PORTATA M³/H
FLOWRATE M³/H

DÉBIT M³/H
CAUDAL M³/H

| Velocità del fluido m/sec Fluid speed m/sec Vitesse du fluide m/sec Velocidad del fluido m/sec | 0,50 | 1,00 | 1,50 | 2,00 |
|---|--------|--------|--------|--------|
| 25,4 | 0,745 | 1,494 | 2,239 | 2,988 |
| 28 | 0,882 | 1,764 | 2,646 | 3,528 |
| 34 | 1,447 | 2,894 | 4,341 | 5,788 |
| 38,1 | 1,785 | 3,571 | 5,356 | 7,142 |
| 40 | 2,041 | 4,082 | 6,123 | 8,164 |
| 50,8 | 3,294 | 6,588 | 9,882 | 13,176 |
| 52 | 3,531 | 7,063 | 10,594 | 14,126 |
| 63,5 | 5,191 | 10,382 | 15,573 | 20,764 |
| 70 | 6,152 | 11,336 | 18,460 | 24,616 |
| 76,2 | 7,509 | 15,019 | 22,528 | 30,038 |
| 85 | 9,270 | 18,540 | 27,810 | 37,080 |
| 101,6 | 14,130 | 28,260 | 42,390 | 56,520 |

PERDITE DI CARICO
PRESSURE DROP

PERTES DE CHARGE
PÉRDIDA DE CARGA

